



Vibro-Insulators®

K69 Series Compression Mounts (Fail-Safe)

K69 Series Features

- Low Cost.
- Ease of installation.
- Encapsulated in Neoprene for use in marine, food processing, and chemical applications.
- Bottom mounting surfaces are ribbed for improved grip.
- Rated for higher loads due to the interlocking metal design.
- Seismic rating of 1g (acceleration of gravity).
- Available in English and Metric hardware.
- Six sizes with 5 load ranges for each size.
- Wide load range from 46 to 8400 pounds of static compressive loads.
- Fail-safe patented designs with interlocking metals.
- No need for snubbing washers.
- Excellent performance with one, two, three, four and five cylinder engines.
- High and Low frequency applications.
- All directional mounts can be used in shear, tension, and compression applications.
- Suited for low mounting applications.

K69 Series Applications

- Motors, generators, and compressors
- HVAC equipment
- Chemical and food processing equipment
- Centrifuges and pumps
- Highway and off-highway machinery
- Trucks, buses, lifts and rail transportation
- Marine equipment and ATV's
- Fans, blowers and portable power equipment
- Seismic protection in earthquake zones

K69 Series Material Data

- Neoprene elastomer available in 30, 40, 50, 60, & 70 Durometer Shore A
 - Operating temperature range (-20° F to 180° F)
 - Ozone resistant
 - Oil, gasoline and solvent resistant
 - Flame resistant
- Structure made of corrosion resistant carbon steel



Karman Rubber offers the largest selection of compression style fail-safe designed mounts available anywhere. With compressive loads starting at just 46 pounds (20 kg) the patent pending K692 Vibro-Isolator® is the smallest compression style fail-safe designed flange mount in the world. Totally encapsulated in the Neoprene elastomer the K692, K635, K696, K697, K698, and K699 mounts are ideally suited toward harsh marine environments or constant wash down applications.

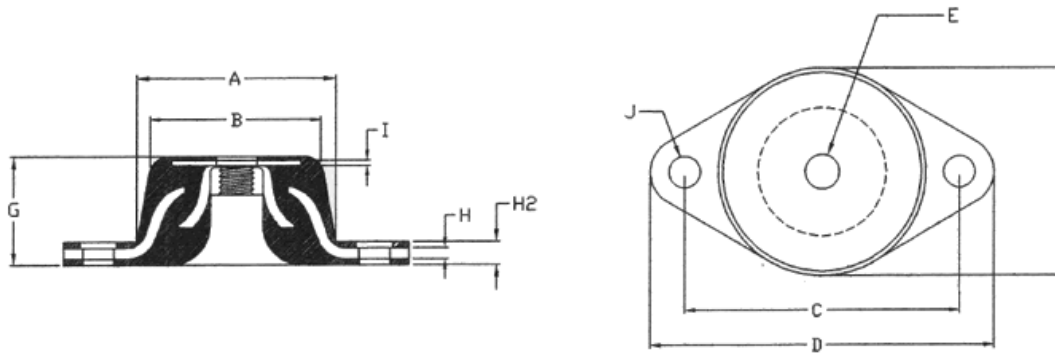

Part Number	Mount Diameter (A)	Top Diameter (B)	Mounting Holes on center (C)	Length (D)	Thread Tap or Hole Size (E)	Width (F)	Height (G)	Insert Thickness (H)	Flange Thickness (H2)	Washer Thickness Washer (I)	Mounting Holes (J)	Spring Rate LBS/INS	Max. Rec. Deflection	Max. Load in LBSMax. Deflection	Part Weight in Ounces
K6920-32	1.13"	.92"	1.75"	2.27"	1/4-20	1.25"	.75"	.05"	.14"	N/A	.26"	879	.052"	46	0.95
K6920-42	1.13"	.92"	1.75"	2.27"	1/4-20	1.25"	.75"	.05"	.14"	N/A	.26"	1687	.052"	87	0.95
K6920-52	1.13"	.92"	1.75"	2.27"	1/4-20	1.25"	.75"	.05"	.14"	N/A	.26"	2230	.052"	115	0.95
K6920-62	1.13"	.92"	1.75"	2.27"	1/4-20	1.25"	.75"	.05"	.14"	N/A	.26"	2643	.052"	137	0.95
K6920-72	1.13"	.92"	1.75"	2.27"	1/4-20	1.25"	.75"	.05"	.14"	N/A	.26"	3441	.052"	179	0.95
K6920-M632	1.13"	.92"	1.75"	2.27"	M6X1.0	1.25"	.75"	.05"	.14"	N/A	.26"	879	.052"	46	0.95
K6920-M642	1.13"	.92"	1.75"	2.27"	M6X1.0	1.25"	.75"	.05"	.14"	N/A	.26"	1687	.052"	87	0.95
K6920-M652	1.13"	.92"	1.75"	2.27"	M6X1.0	1.25"	.75"	.05"	.14"	N/A	.26"	2230	.052"	115	0.95
K6920-M662	1.13"	.92"	1.75"	2.27"	M6X1.0	1.25"	.75"	.05"	.14"	N/A	.26"	2643	.052"	137	0.95
K6920-M672	1.13"	.92"	1.75"	2.27"	M6X1.0	1.25"	.75"	.05"	.14"	N/A	.26"	3441	.052"	179	0.95
K6350-32	1.50"	1.20"	2.375"	3.13"	5/16-18	1.73"	1.02"	.07"	.19"	N/A	.34"	1200	.08"	85	2.7
K6350-42	1.50"	1.20"	2.375"	3.13"	5/16-18	1.73"	1.02"	.07"	.19"	N/A	.34"	2200	.08"	160	2.7
K6350-52	1.50"	1.20"	2.375"	3.13"	5/16-18	1.73"	1.02"	.07"	.19"	N/A	.34"	3100	.08"	250	2.7
K6350-62	1.50"	1.20"	2.375"	3.13"	5/16-18	1.73"	1.02"	.07"	.19"	N/A	.34"	4300	.08"	340	2.7
K6350-72	1.50"	1.20"	2.375"	3.13"	5/16-18	1.73"	1.02"	.07"	.19"	N/A	.34"	8500	.08"	570	2.7
K6350-M832	1.50"	1.20"	2.375"	3.13"	M8X1.25	1.73"	1.02"	.07"	.19"	N/A	.34"	1200	.08"	85	2.7
K6350-M842	1.50"	1.20"	2.375"	3.13"	M8X1.25	1.73"	1.02"	.07"	.19"	N/A	.34"	2200	.08"	160	2.7
K6350-M852	1.50"	1.20"	2.375"	3.13"	M8X1.25	1.73"	1.02"	.07"	.19"	N/A	.34"	3100	.08"	250	2.7
K6350-M862	1.50"	1.20"	2.375"	3.13"	M8X1.25	1.73"	1.02"	.07"	.19"	N/A	.34"	4300	.08"	340	2.7
K6350-M872	1.50"	1.20"	2.375"	3.13"	M8X1.25	1.73"	1.02"	.07"	.19"	N/A	.34"	8500	.08"	570	2.7
K6960-32	2.15"	1.60"	3.00"	3.81"	3/8-16	2.32"	1.25"	.12"	.24"	.065"	.34"	2100	.10"	210	6.5
K6960-42	2.15"	1.60"	3.00"	3.81"	3/8-16	2.32"	1.25"	.12"	.24"	.065"	.34"	3700	.10"	340	6.5
K6960-52	2.15"	1.60"	3.00"	3.81"	3/8-16	2.32"	1.25"	.12"	.24"	.065"	.34"	5200	.10"	520	6.5
K6960-62	2.15"	1.60"	3.00"	3.81"	3/8-16	2.32"	1.25"	.12"	.24"	.065"	.34"	6800	.10"	680	6.5
K6960-72	2.15"	1.60"	3.00"	3.81"	3/8-16	2.32"	1.25"	.12"	.24"	.065"	.34"	9400	.10"	750	6.5
K6960-M832	2.15"	1.60"	3.00"	3.81"	M8X1.25	2.32"	1.25"	.12"	.24"	.065"	.34"	2100	.10"	210	6.5
K6960-M842	2.15"	1.60"	3.00"	3.81"	M8X1.25	2.32"	1.25"	.12"	.24"	.065"	.34"	3700	.10"	340	6.5
K6960-M852	2.15"	1.60"	3.00"	3.81"	M8X1.25	2.32"	1.25"	.12"	.24"	.065"	.34"	5200	.10"	520	6.5
K6960-M862	2.15"	1.60"	3.00"	3.81"	M8X1.25	2.32"	1.25"	.12"	.24"	.065"	.34"	6800	.10"	680	6.5
K6960-M872	2.15"	1.60"	3.00"	3.81"	M8X1.25	2.32"	1.25"	.12"	.24"	.065"	.34"	8400	.10"	750	6.5
K6980-B32	3.23"	2.42"	4.12"	5.50"	1/2-13	3.37"	1.78"	.12"	.24"	.12"	.51"	3800	.125"	471	17
K6980-B42	3.23"	2.42"	4.12"	5.50"	1/2-13	3.37"	1.78"	.12"	.24"	.12"	.51"	5800	.125"	713	17
K6980-B52	3.23"	2.42"	4.12"	5.50"	1/2-13	3.37"	1.78"	.12"	.24"	.12"	.51"	7500	.125"	940	17
K6980-B62	3.23"	2.42"	4.12"	5.50"	1/2-13	3.37"	1.78"	.12"	.24"	.12"	.51"	8650	.125"	1064	17
K6980-B72	3.23"	2.42"	4.12"	5.50"	1/2-13	3.37"	1.78"	.12"	.24"	.12"	.51"	13000	.125"	1600	17
K6980-M1232	3.23"	2.42"	4.12"	5.50"	M12X1.75	3.37"	1.78"	.12"	.24"	.12"	.51"	3800	.125"	471	17
K6980-M1242	3.23"	2.42"	4.12"	5.50"	M12X1.75	3.37"	1.78"	.12"	.24"	.12"	.51"	5800	.125"	713	17
K6980-M1252	3.23"	2.42"	4.12"	5.50"	M12X1.75	3.37"	1.78"	.12"	.24"	.12"	.51"	7500	.125"	940	17
K6980-M1262	3.23"	2.42"	4.12"	5.50"	M12X1.75	3.37"	1.78"	.12"	.24"	.12"	.51"	8650	.125"	1064	17
K6980-M1272	3.23"	2.42"	4.12"	5.50"	M12X1.75	3.37"	1.78"	.12"	.24"	.12"	.51"	13000	.125"	1600	17
K6990-C32	3.91"	3.10"	5.00"	6.41"	3/4-10 HD	4.09"	1.84"	.12"	.24"	.12"	.53"	7577	.125"	640	29
K6990-C42	3.91"	3.10"	5.00"	6.41"	3/4-10 HD	4.09"	1.84"	.12"	.24"	.12"	.53"	9285	.125"	990	29
K6990-C52	3.91"	3.10"	5.00"	6.41"	3/4-10 HD	4.09"	1.84"	.12"	.24"	.12"	.53"	13071	.125"	1660	29
K6990-C62	3.91"	3.10"	5.00"	6.41"	3/4-10 HD	4.09"	1.84"	.12"	.24"	.12"	.53"	20119	.125"	2145	29
K6990-C72	3.91"	3.10"	5.00"	6.41"	3/4-10 HD	4.09"	1.84"	.12"	.24"	.12"	.53"	34400	.125"	3245	29
K6990-M2032	3.91"	3.10"	5.00"	6.41"	M20X2.5	4.09"	1.84"	.12"	.24"	.12"	.53"	7577	.125"	640	29
K6990-M2042	3.91"	3.10"	5.00"	6.41"	M20X2.5	4.09"	1.84"	.12"	.24"	.12"	.53"	9285	.125"	990	29
K6990-M2052	3.91"	3.10"	5.00"	6.41"	M20X2.5	4.09"	1.84"	.12"	.24"	.12"	.53"	13071	.125"	1660	29
K6990-M2062	3.91"	3.10"	5.00"	6.41"	M20X2.5	4.09"	1.84"	.12"	.24"	.12"	.53"	20119	.125"	2145	29
K6990-M2072	3.91"	3.10"	5.00"	6.41"	M20X2.5	4.09"	1.84"	.12"	.24"	.12"	.53"	34400	.125"	3245	29
K6970-C32	4.93"	4.12"	6.00"	7.41"	3/4-10 HD	5.10"	2.25"	.156"	.27"	.12"	.63"	13375	.17"	1735	51
K6970-C42	4.93"	4.12"	6.00"	7.41"	3/4-10 HD	5.10"	2.25"	.156"	.27"	.12"	.63"	20750	.17"	2630	51
K6970-C52	4.93"	4.12"	6.00"	7.41"	3/4-10 HD	5.10"	2.25"	.156"	.27"	.12"	.63"	24264	.17"	3650	51

K6970-C62	4.93"	4.12"	6.00"	7.41"	3/4-10 HD	5.10"	2.25"	.156"	.27"	.12"	.63"	39058	.17"	5720	51
K6970-C72	4.93"	4.12"	6.00"	7.41"	3/4-10 HD	5.10"	2.25"	.156"	.27"	.12"	.63"	49509	.17"	7750	51
K6970-M2032	4.93"	4.12"	6.00"	7.41"	M20X2.5	5.10"	2.25"	.156"	.27"	.12"	.63"	13375	.17"	1735	51
K6970-M2042	4.93"	4.12"	6.00"	7.41"	M20X2.5	5.10"	2.25"	.156"	.27"	.12"	.63"	20750	.17"	2630	51
K6970-M2052	4.93"	4.12"	6.00"	7.41"	M20X2.5	5.10"	2.25"	.156"	.27"	.12"	.63"	24264	.17"	3650	51
K6970-M2062	4.93"	4.12"	6.00"	7.41"	M20X2.5	5.10"	2.25"	.156"	.27"	.12"	.63"	39058	.17"	5720	51
K6970-M2072	4.93"	4.12"	6.00"	7.41"	M20X2.5	5.10"	2.25"	.156"	.27"	.12"	.63"	49509	.17"	7750	51

Karman Rubber
 2331 Copley Road • Akron, OH 44320
 P: (330) 864-2161 • F: (330)864-2124
 Web: www.karman.com
 Email: karman@karman.com