



Vibro-Insulators®

Compression Mounts (Dome Style Fail-Safe)



AVAILABLE WITH 3/4 - 10 THREAD

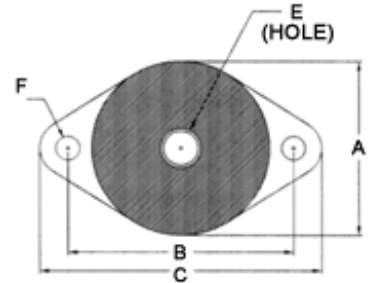
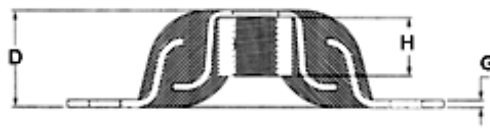

Part Number	A	B	C	D	E	F	G	H	Axial Spring Rate LBS/IN	Axial Max. Recommended Deflection	Axial Loads in LBS @ Max. Deflection	Elastomer	Availability
K61-40	3.25"	4.12"	5.38"	1.66"	1/2"	.53"	.12"	N/A	3000	.125"	375	NEOPRENE	4 TO 6 WEEKS
K61-50	3.25"	4.12"	5.38"	1.66"	1/2"	.53"	.12"	N/A	6400	.125"	800	NEOPRENE	4 TO 6 WEEKS
K61-60	3.25"	4.12"	5.38"	1.66"	1/2"	.53"	.12"	N/A	7400	.125"	925	NEOPRENE	4 TO 6 WEEKS
K61-70	3.25"	4.12"	5.38"	1.66"	1/2"	.53"	.12"	N/A	11500	.125"	1425	NEOPRENE	4 TO 6 WEEKS
K62-C40	3.94"	5.00"	6.25"	1.66"	3/4"	.53"	.12"	N/A	4150	.125"	525	NEOPRENE	4 TO 6 WEEKS
K62-C50	3.94"	5.00"	6.25"	1.66"	3/4"	.53"	.12"	N/A	8300	.125"	1000	NEOPRENE	4 TO 6 WEEKS
K62-C60	3.94"	5.00"	6.25"	1.66"	3/4"	.53"	.12"	N/A	10000	.125"	1250	NEOPRENE	4 TO 6 WEEKS
K62-C70	3.94"	5.00"	6.25"	1.66"	3/4"	.53"	.12"	N/A	15600	.125"	1950	NEOPRENE	4 TO 6 WEEKS
K62-S40	3.94"	5.00"	6.25"	1.66"	5/8"	.53"	.12"	N/A	4150	.125"	525	NEOPRENE	4 TO 6 WEEKS
K62-S50	3.94"	5.00"	6.25"	1.66"	5/8"	.53"	.12"	N/A	8300	.125"	1000	NEOPRENE	4 TO 6 WEEKS
K62-S60	3.94"	5.00"	6.25"	1.66"	5/8"	.53"	.12"	N/A	10000	.125"	1250	NEOPRENE	4 TO 6 WEEKS
K62-S70	3.94"	5.00"	6.25"	1.66"	5/8"	.53"	.12"	N/A	15600	.125"	1950	NEOPRENE	4 TO 6 WEEKS

Karman Rubber
 2331 Copley Road • Akron, OH 44320
 P: (330) 864-2161 • F: (330)864-2124
 Web: www.karman.com
 Email: karman@karman.com