

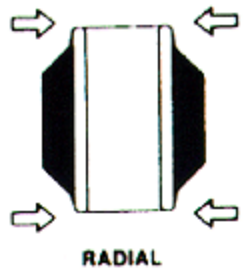

Vibro-Insulators®

Center Bonded Bushings

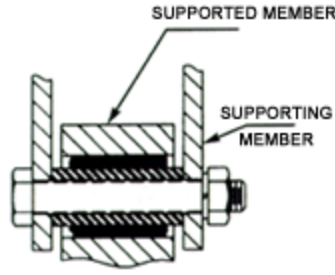
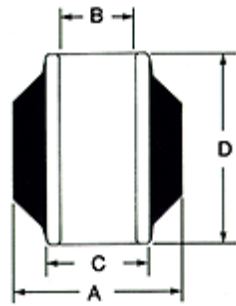

The K22 is a one piece center bonded mount that is compressed and fitted into a socket with a 1.285" diameter and 1.44" length. The radial load deflections specified were tested in this manner.

Part Number	Diameter (A)	Diameter (B)	Diameter (C)	Height (D)	Shore a Durometer	Radial Spring Rate LBS/IN	Radial Maximum Recommended Deflection	Radial Load In LBS @ Max. Deflection	Elastomer	Availability
K22-40	1.37"	.635 / .645"	.87"	1.62"	40	11500	.025"	280	NATURAL RUBBER	4 TO 6 WEEKS
K22-50	1.37"	.635 / .645"	.87"	1.62"	50	15100	.025"	380	NATURAL RUBBER	4 TO 6 WEEKS
K22-60	1.37"	.635 / .645"	.87"	1.62"	60	21000	.025"	520	NATURAL RUBBER	4 TO 6 WEEKS
K22-70	1.37"	.635 / .645"	.87"	1.62"	70	24800	.025"	620	NATURAL RUBBER	4 TO 6 WEEKS
K222-40	2.39"	1.318 / 1.324"	1.50"	2.24"	40	12000	.04"	480	NATURAL RUBBER	4 TO 6 WEEKS
K222-50	2.39"	1.318 / 1.324"	1.50"	2.24"	50	16000	.04"	640	NATURAL RUBBER	4 TO 6 WEEKS
K222-60	2.39"	1.318 / 1.324"	1.50"	2.24"	60	21000	.04"	840	NATURAL RUBBER	4 TO 6 WEEKS
K222-70	2.39"	1.318 / 1.324"	1.50"	2.24"	70	26000	.04"	1040	NATURAL RUBBER	4 TO 6 WEEKS

Karman Rubber
 2331 Copley Road • Akron, OH 44320
 P: (330) 864-2161 • F: (330)864-2124
 Web: www.karman.com
 Email: karman@karman.com